

Corporate Events

Tuke's Chamber & The Corsellis Room



Above
Fine wines and candlelight make the Corsellis Room a distinctive place for an evening dinner.

Below
The Boardwalk across the pond offers a relaxing wander near to the buildings.

The two larger conference rooms are known as Tuke's Chamber and the Corsellis Room.

Tuke's Chamber and the Corsellis Room are situated on the first floor, above what used to be the dairy, larder and bakery. Both have fine pincer beam roofs, original wattle and daub walls and polished oak flooring.

Both rooms may be completely blacked out, and the Mulberry wall hangings of the Corsellis Room conceal behind them a large projector screen. The rooms benefit from excellent acoustics, so a sound system is not usually required.

Option 1: Tuke's Chamber - buffet, Corsellis Room - theatre

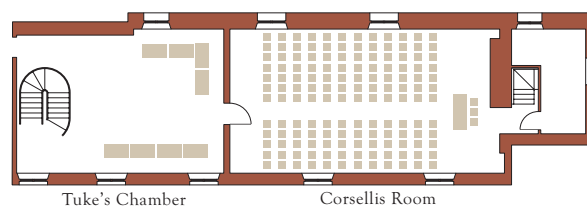

Option 2: Tuke's Chamber - exhibition display, Corsellis Room - cabaret

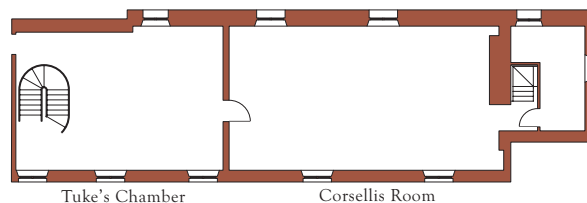

Typical format for an in house conference of 120 people

9.00am	Delegates arrive, coffee in Tuke's Chamber.
9.30am	Presentations in the Corsellis Room.
11.00am	Coffee in Tuke's Chamber or, weather permitting, in the Retainers courtyard.
11.30am	Presentations continue.
1.00pm	Lunch in Long Gallery, with delegates able to stretch their legs within the gardens, farm and grounds.
2.00pm	Delegates split into seminar groups, using the five meeting rooms of East Court, as well as Tuke's Chamber.
4.00pm	Plenary session in the Corsellis room.
4.20pm	Tea and biscuits in Tuke's Chamber, followed by departure.

Room	Dimensions		Capacity			Sockets		
	Feet	Metres	Boardroom	Theatre	Cabaret	13A	Data	Phone
The Corsellis Room	41x23'6	12.7x7.1	40	120	72	20	8	8
Tuke's Chamber	34x23'6	10.3x7.1	30	70	50	20	4	4

A loop system is present in Tuke's Chamber and the Corsellis Room.